

WG5024

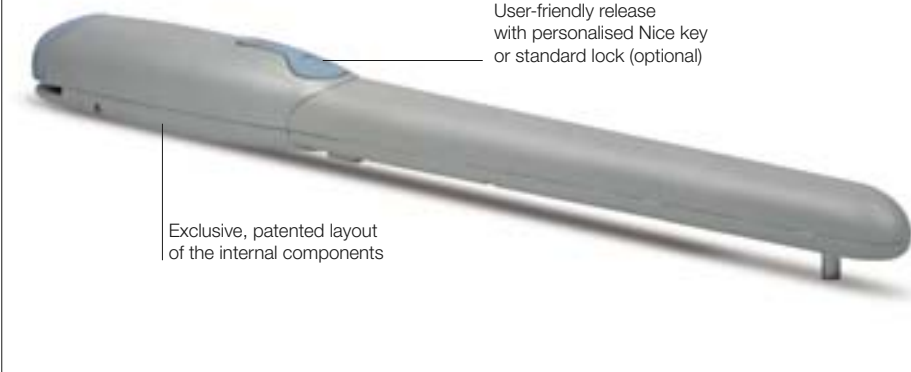

For swing gates with leaves up to 3.5 m, surface mounted.
24 Vdc electromechanical gear motor.

Compatible for operation with Solemyo system.

Patented layout of the internal components: fewer moving parts **means greater reliability and quiet operation.**

Easy to install: after the gear motor has been assembled, all electrical connections are made from above.

User-friendly release with personalised Nice key or standard lock (optional).

Pre-assembled, **travel stops** PLA13 on opening.

New Moonclever control unit MC424:

- simple programming, by means of a single key;
- clutch with anti-crush safety feature;
- automatic memorization of limit switches on opening and closing with self-learning function;
- programming of pause time;
- pedestrian pass door;
- deceleration on opening and closing;
- obstacle detection system;
- can be linked to the 8.2 KOhm resistive sensitive edge;
- continues to work even during power failures using optional (PS124) batteries that fit inside the control unit.



The kit contains:

WG5024 2 surface-mounted electromechanical gear motors, with Nice key release.
FLO2R-S 1 transmitter 433.92 MHz, 2 channels. **MC424** 1 control unit with SMXI plug-in receiver.
MOF 1 pair of photocells for outdoor installation. **MOSE** 1 key selector switch for outdoor installation.
ML24T 1 flashing light with integrated aerial. **PLA13** 2 travel stops for opening manoeuvres. **TS** 1 signboard.

Technical specifications

Code	WG5024
Electrical data	
Power supply (Vdc)	24
Absorption (A)	3.5
Power (W)	85
Built-in capacitor (µF)	-
Performance data	
Speed (m/s)	0.016
Force (N)	1500
Work cycle (cycles/hour)	30
Dimensional and general data	
Protection level (IP)	44
Working temp. (°C Min/Max)	-20 ÷ +50
Dimensions (mm)	920x98x95 h
Weight (kg)	18

Installation diagram

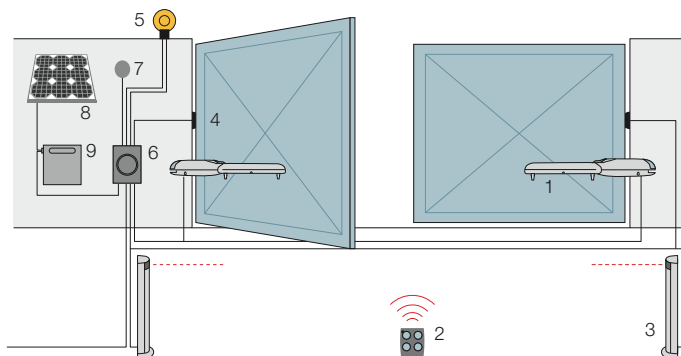

1. Wingo 2. Transmitter 3. Photocells mounted on posts 4. Photocells 5. Flashing light 6. Control unit
7. Digital or key switches 8. SYP* solar panel 9. PSY24* battery box.
*Optional connection to Solemyo system.

Utilisation limits

